

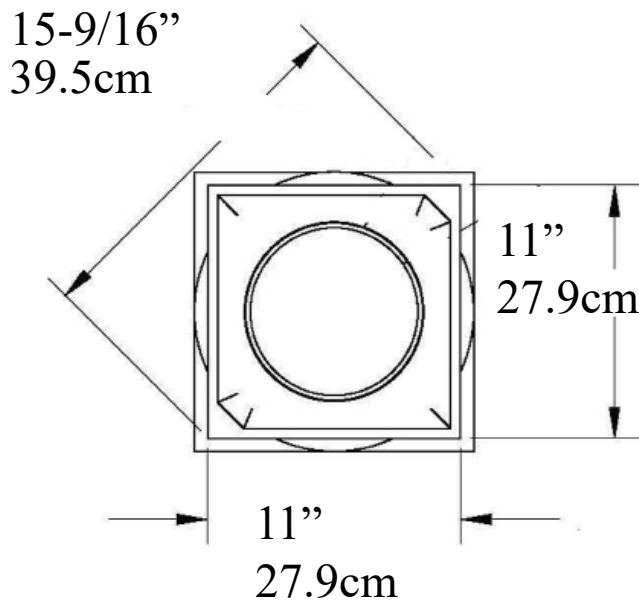

# Attic Base

## IPATTC100 ArchPolymer™



Hole 8-1/4" (20.9cm)  
Circumference  
25.9 inches

Total Height

4-3/4" (12cm)

Top Round 3-1/8"

Plinth Height 1-5/8"



Weight

1.1 lb

.5 kg

***Made from Molds***

High density Synthetic Polyurethane

Interior & Exterior Use

Insect, Rot, Water Resistant

Same Density as White Pine

\* All specifications subject to change without notice,  
Final products & Measurements may vary from this brochure Manufacturing tolerances +/- 1/8" (.31cm)



Imperial Productions®

1-800-399-7585

Imperial Productions & Distribution Inc.

email sales@imperialproductions.com copyright 2016 MRDCI All Rights Reserved

APR-23